



WELLINGTON

2081 asf • 593 W Cedarburg Dr.

3 bed + office-flex room, 2.5 baths, Oversized 2-car garage

— CUSTOM-CRAFTED UPGRADES —

9' and 14' ceilings
Ceramic tile flooring
Engineered hardwood flooring
12' Grand foyer with architectural inset
Hand-textured walls
Matte black hardware
True Lap siding with stone accents

— KITCHEN —

Full ceiling height custom alder stained & paint-grade cabinets
Large walk-in pantry
Quartz countertops with full accented tile backsplash
Large center entertainment island – open to great room
GE Profile stainless steel appliance package

— PRIMARY BEDROOM SUITE —

Tile flooring and quartz countertops
Dual vanity sinks, separate room for water closet
Walk-in tiled shower, large walk-in closet

— GREAT ROOM —

Gas fireplace with mantle & stone accents
Built-in entertainment center cabinets, 14' ceilings
Access to entertaining covered patio

...Please see Reverse Side for More Details...

DEVELOPED BY



JON SHULTZ
208.761.2047
jshultz@cbboise.com

KEVIN O'HARA
208 890-6111
kohara@cbboise.com



COLDWELL BANKER
TOMLINSON

www.CherryBlossomMeridian.com



Separate office-flex room adjacent to Great Room
Built-in desk & Quartz countertop

— LAUNDRY ROOM —

Spacious laundry room with large folding table, cabinets, mud bench & tile flooring
Quartz countertops with deep utility sink

— GUEST BATH —

Tile flooring & Quartz countertops, full tub/shower surround & dual vanities
Additional ½ bath off great room

— GARAGE & EXTERIOR —

Oversized 2-car garage with opener, keyless entry & carriage garage doors
Plumbed for water softener
Covered rear patio with gas BBQ line, full perimeter fencing
220 Volt

— CONVENIENT DOWNTOWN MERIDIAN ACCESS —

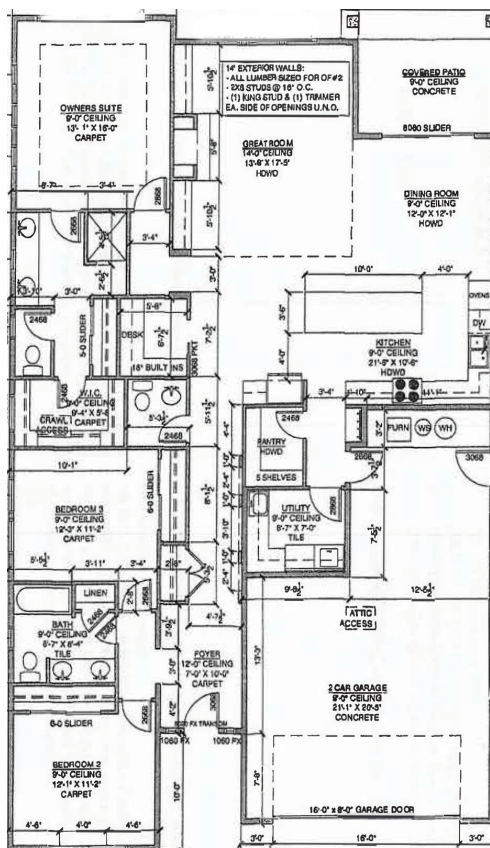

Floor Plan Similar



Elevation Similar

WELLINGTON

FLOOR PLAN

2081 ASF



DEVELOPED BY



JON SHULTZ
208.761.2047
jshultz@cbboise.com

KEVIN O'HARA
208 890-6111
kohara@cbbojse.com



COLDWELL BANKER
TOMLINSON

Information deemed reliable, but not guaranteed. Buyer to verify all information. If currently listed with a Broker, this is not intended as solicitation.